

# QUANTUM QL3

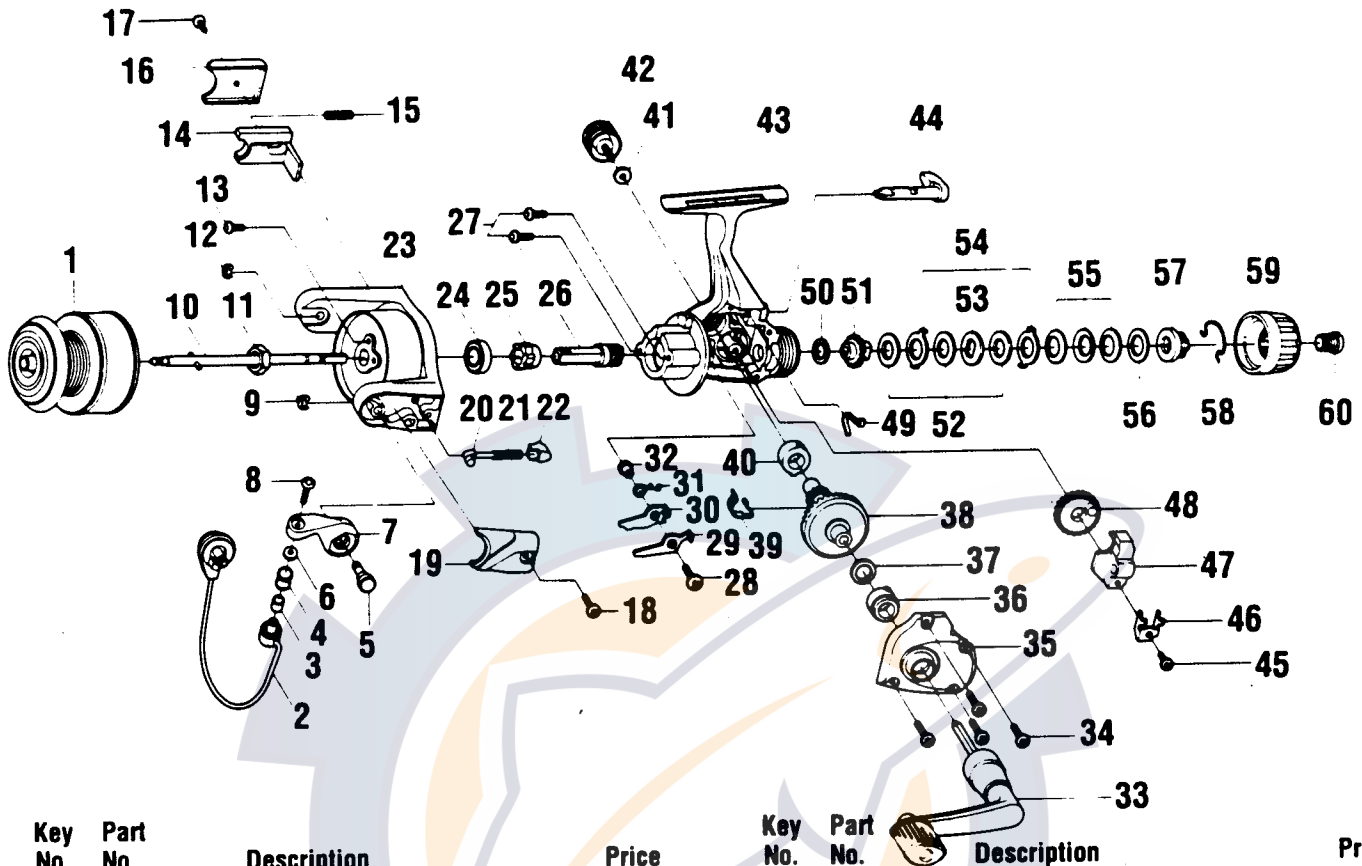

| Key No. | Part No. | Description                  | Price | Key No. | Part No. | Description               | Price |
|---------|----------|------------------------------|-------|---------|----------|---------------------------|-------|
| 1       | JU321-19 | Spool Assembly               | 10.15 | 31      | JU061-01 | Anti-Reverse Pawl Spring  | 1.00  |
| 2       | GU347-04 | Bail Assembly                | 5.95  | 32      | GU091-02 | Anti-Reverse Pawl Post    | .70   |
| 3       | MT016-02 | Line Roller Bushing          | .75   | 33      | GU318-33 | Handle Assembly           | 5.15  |
| 4       | MT004-01 | Line Roller                  | 1.20  | 34      | JU057-01 | Body Cover Screw          | .60   |
| 5       | GU051-04 | Arm Lever Pin                | .55   | 35      | JU023-09 | Body Cover                | 2.35  |
| 6       | GU105-07 | Line Roller Washer           | .15   | 36      | JU027-01 | Gear Shaft Bushing        | 1.55  |
| 7       | NU007-01 | Arm Lever                    | .90   | 37      | GU105-13 | Adjustment Washr          | .62   |
| 8       | KQ108-01 | Line Slider Screw            | .30   | 38      | JU012-01 | Drive Gear                | 3.35  |
| 9       | KQ034-01 | E-Clip                       | .15   | 39      | JU086-01 | Silent Cam                | 1.10  |
| 10      | JU315-01 | Main Shaft Assembly          | 1.75  | 40      | JU027-01 | Gear Shaft Bushing        | 1.55  |
| 11      | GU006-02 | Rotor Nut                    | .80   | 41      | GU105-01 | Handle Screw Washer       | .10   |
| 12      | KQ034-01 | E-Clip                       | .15   | 42      | GU073-01 | Handle Screw              | .60   |
| 13      | GU077-04 | Rotor Nut Lock Screw         | .15   | 43      | JU001-09 | Body                      | 10.05 |
| 14      | JU019-01 | Kick Lever                   | 1.00  | 44      | GU090-01 | Anti-Reverse Lever        | 1.45  |
| 15      | KQ049-06 | Kick Lever Spring            | .25   | 45      | JU100-01 | Oscillator Retainer Screw | .25   |
| 16      | JU046-01 | Kick Lever Cover             | .75   | 46      | JU078-01 | Oscillator Slide Retainer | .30   |
| 17      | GU077-02 | Kick Lever Cover Scrw        | .15   | 47      | JU025-01 | Oscillator Slider         | 1.75  |
| 18      | GU077-02 | Arm Lever Cover Screw        | .15   | 48      | JU053-01 | Oscillator Gear           | 1.75  |
| 19      | NU086-01 | Arm Lever Spring Cover       | .75   | 49      | GU089-01 | Anti-Reverse Lever Spring | .50   |
| 20      | QL031-01 | Arm Lever Spring Pin         | .75   | 50      | GU105-32 | Drag Friction Washer      | .77   |
| 21      | KQ049-02 | Arm Lever Spring             | .85   | 51      | JU075-01 | Drag Click Gear           | 1.25  |
| 22      | QL020-01 | Arm Lever Spring Holder      | .30   | 52      | GU105-33 | Drag Washer "B"           | .88   |
| 23      | JU009-12 | Rotor                        | 3.70  | 53      | JU080-01 | Drag Washer "D"           | 1.00  |
| 24      | AQ028-06 | Ball Bearing                 | 6.10  | 54      | JU081-01 | Drag Washer "A"           | 1.00  |
| 25      | JU060-01 | Anti-Reverse Ratchet         | 2.35  | 55      | JU043-01 | Drag Spring               | 1.30  |
| 26      | JU011-01 | Pinion Gear                  | 2.30  | 56      | GU105-19 | Drag Washer               | .93   |
| 27      | JU077-01 | Bearing Screw                | .60   | 57      | JU066-01 | Drag Nut                  | 1.25  |
| 28      | GU077-05 | Anti-Reverse Pawl Screw      | .15   | 58      | JU083-01 | Drag Click Spring         | 1.85  |
| 29      | JU063-01 | Anti-Reverse Pawl "A" (Cntr) | .95   | 59      | JU032-01 | Drag Knob                 | 1.50  |
| 30      | JU074-01 | Anti-Reverse Pawl "B" (On)   | .95   | 60      | JU101-01 | Drag Knob Screw           | 1.25  |

Prices subject to change without notice. Prices do not include postage and handling.

**PLEASE ORDER BY PART NUMBER**

Rev. 6/95

Zebco Division Brunswick Corporation, Box 270, Tulsa, OK 74101 USA 918-836-5581

